

PP/St - Flanges

Material:

- PP glasfiber reinforced with steel core
- High bending strength

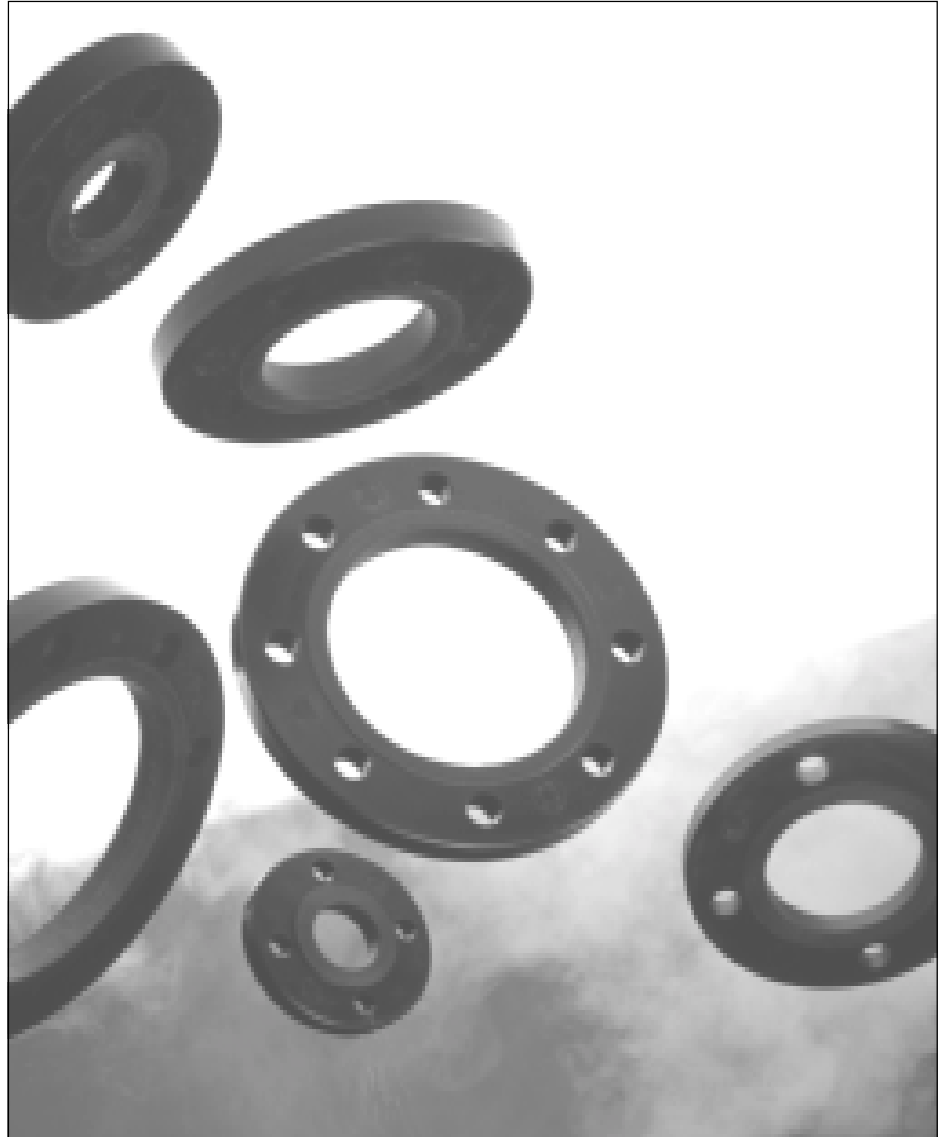

Corrosion-resistance:

- Weldless injection moulded PP coating

ASV quality control:

- High voltage test with 30 kV of PP coating

Standard sizes:

- Connection dimensions acc. to ISO / DIN 2501, PN 10
- For flange adaptor and welding necks acc. to ISO / DIN

Applications:

- All types of chemical fields and industries
- Plants and apparatus engineering
- General mechanical engineering

PP/steel flanges:

- High operational reliability at permanent load.

Flange connection:

- No deforming by controlled torque.

Heat-stabilized:

- At permanent temperature up to +80 °C

Future oriented technology:

- Developed for the requirements of the chemical industry.
- Manufactured acc. to the state-of-the-art thermoplastic technology.



Sectional sketch showing the wallthickness of the coating and the metal core (no diffusion).

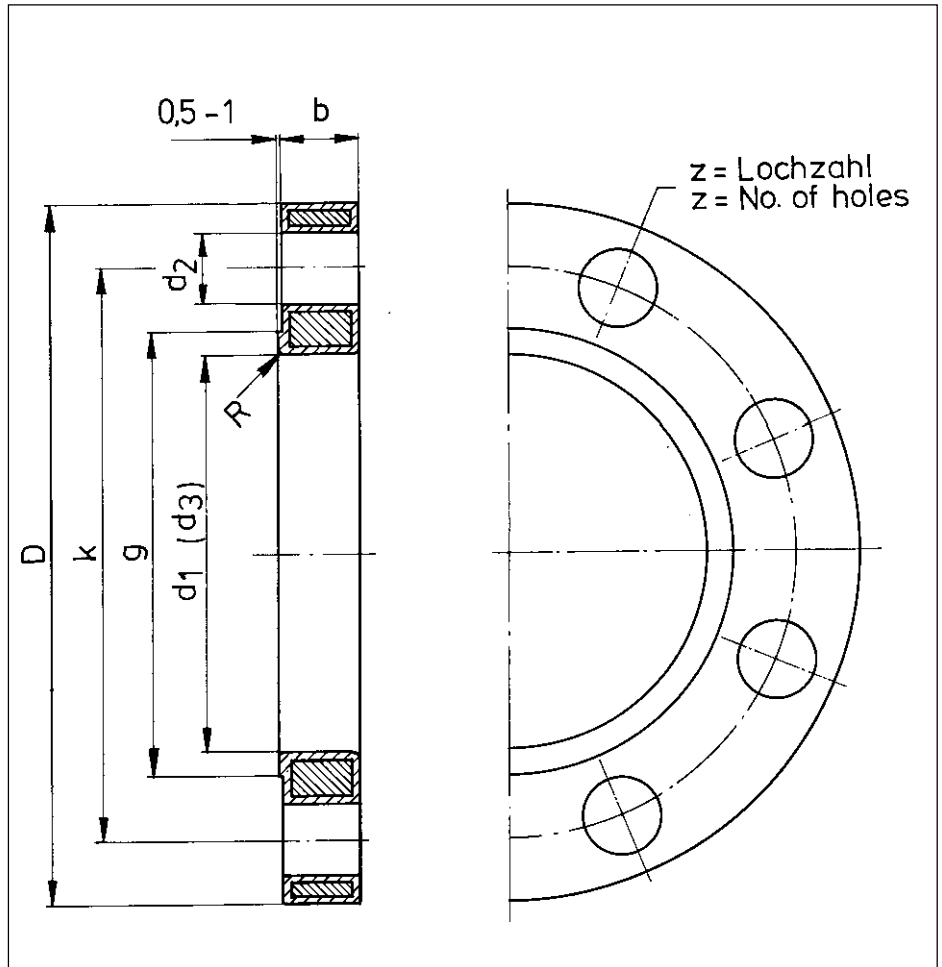

Flanges, form A (ID = d1), for standard flange adaptors made out of PVC-U, PVC-C, PP, PE, PVDF or ABS.
Flanges for ANSI-, JIS-, BS-flange adaptors on request.
Marking with BB from DN 80 on = flange adaptor

size		dimensions mm								ident- No.	pressure stage PN	screw torques Nm ²	weight g
d	DN	D	d1	g	b	R	k	d2	z				
20	15	95	28	45	13.0	2.0	65	14	4	61683	16	10	200
25	20	106	34	58	14.5	2.0	75	14	4	61684	16	15	300
32	25	116	42	68	15.5	2.0	85	14	4	61685	16	15	360
40	32	141	51	78	17.5	2.0	100	18	4	61686	16	20	600
50	40	151	62	88	17.5	2.0	110	18	4	61687	16	30	650
63	50	166	78	102	19.0	2.5	125	18	4	62635	16	35	730
75	65	186	92	122	19.0	2.5	145	18	4	62636	16	40	1140
90	80	201	110	136	21.0	3.0	160	18	8	62638	16	40	1350
110	100	221	133	157	22.0	3.0	180	18	8	62640	16	50	1470
140	125	251	167	188	26.0	4.0	210	18	8	62643	16	60	1800
160	150	286	190	212	27.0	4.0	240	22	8	62646	16	60	2500
225	200	341	250	270	28.0	4.0	295	22	8	62649	10 ¹⁾	75	3600

Flanges, form A (ID = d3), for welding necks made out of PP, PE or PVDF.
Flanges for ANSI-, JIS-, BS-flange adaptors on request.
Marking with VB from DN 80 on = welding neck

size		dimensions mm								ident- No.	pressure stage PN	screw torques Nm ²	weight g
d	DN	D	d3	g	b	R	k	d2	z				
20	15	95	28	45	13.0	2.0	65	14	4	61683	16	10	200
25	20	106	34	58	14.5	2.0	75	14	4	61684	16	15	300
32	25	116	42	68	15.5	2.0	85	14	4	61685	16	15	360
40	32	141	51	78	17.5	2.0	100	18	4	61686	16	20	600
50	40	151	62	88	17.5	2.0	110	18	4	61687	16	25	650
63	50	166	78	102	19.0	2.5	125	18	4	62635	16	35	730
75	65	186	92	122	19.0	2.5	145	18	4	62636	16	40	1140
90	80	201	108	136	21.0	3.0	160	18	8	62637	16	40	1350
110	100	221	128	157	22.0	3.0	180	18	8	62639	16	50	1470
125	100	221	135	157	22.0	3.0	180	18	8	62641	16	50	1500
140	125	251	158	188	26.0	4.0	210	18	8	62642	16	60	1800
160	150	286	178	212	27.0	4.0	240	22	8	62644	16	60	2500
180	150	286	188	212	27.0	4.0	240	22	8	62645	16	60	2460
200	200	341	235	270	28.0	4.0	295	22	8	62647	10 ¹⁾	75	4000
225	200	341	238	270	28.0	4.0	295	22	8	62648	10 ¹⁾	75	3960
250	250	406	288	320	31.0	4.0	350	22	12	62650	10 ¹⁾	95	6050
280	250	406	294	320	31.0	4.0	350	22	12	62651	10 ¹⁾	95	5950
315	300	460	338	370	34.0	4.0	400	22	12	62652	10 ¹⁾	100	9550
355	350	520	376	430	39.0	4.0	460	22	16	62653	10 ¹⁾	100	12300
400	400	580	430	490	42.0	4.0	515	26	16	62777	10 ¹⁾	100	16000

¹⁾ from DN 200 upwards the flange connection can be loaded by the operating pressure with up to 16 bar.
Please note: Consider admissible operating pressure of sealings and gaskets.

²⁾ standard values

Flange connection with PP/steel flanges in PVC-U pipelines.



PP/steel flanges for operationally reliable pipeline connection:

- No corrosion by diffusion due to PP coating.

Reproducible dimensional accuracy:

- Full automatic optimized injection moulding technology.

State-of-the-art production:

- Guarantees price-wise competitive high quantity output and fast supply.

ASV quality control:

- Guarantees high application benefits.